

**hydratight**

# Torque Solutions



# Because ensuring a leak-free solution is critical. It has to be Hydratight.

For more than 100 years, Hydratight has provided world-class bolted joint solutions, assessing and managing joints to ensure leak-free start-ups. Today, we continue to set international standards in joint integrity – but we're so much more than just a bolting and on-site machining company.

Because even the tiniest leak can be costly and time consuming to repair, we manage every joint on a project for leak-free start-ups and production, which in turn removes the threat of environmental impact caused by unsafe joints. Safety continues to be the most important aspect of our business. We are a global organisation making a real difference to the industries and communities we work in, committed to improving safety, operational efficiency and uptime.

Because you require the support of an innovative partner committed to your success, we not only offer unrivalled service on a global scale, including customer training and software development; but also design and manufacture quality tools and equipment for bolted joint solutions to the highest standards. Our certified teams are dedicated to working closely with you, assessing and managing every joint on your project to prevent leaks from ever occurring, year in, year out.

Because you value safety and reliability, we work to ISO 9001, ISO 14001 and OHSAS 18001 standards in everything we produce from manufacturing torque and tension bolting equipment to mechanical connectors, from in-situ service to creating custom solutions in line with clients' specifications.

It means that whenever you need a complete joint integrity solution, whichever industry sector you're in, you can rely on us to get it 100% right first time, every time. **This is why it has to be Hydratight.**



## Engineering Driven Safety Focused Solutions





## Torque Products

At Hydratight we have a strong reputation for our range of hydraulic torque wrenches - based on a steel alloy, they are strong, reliable and designed with the user in mind.



We design and manufacture all of our hydraulic wrenches at our manufacturing facility in Antigo, North America. This facility is purpose-built for the manufacturing of torque equipment to ensure we maintain full control throughout the build process. We also offer a choice of interchangeable tools; with the square drive being replaced by a low profile cassette to provide increased flexibility, or a dedicated square drive and low profile option so that weight and size can be optimal.



# Hydraulic Torque Wrenches

Hydratight's series of lightweight hydraulic torque wrenches has been designed to tighten and loosen nuts and bolts for professional applications across the oil & gas, powergen and industrial markets.

## Safe

- Innovative design that completely encloses all moving parts and eliminates pinch points

## Fast

- 30 – 35 degrees of operating stroke provides added productivity while avoiding “tool lock on” which is common with some torque wrench designs

## Versatile

- Interchangeable head design
- Power head / square drive combination for flexible use with standard impact quality sockets
- Power head / hex head combination for limited height in line solutions
- Wide range of hex sizes available for all applications
- 360 degree movement of reaction arm with simple dial lock for rapid change
- For use topside and subsea

## Compact

- Designed to give optimum strength to weight and torque to weight ratios
- Minimum nose radius for trouble-free tool fit

## Durable

- Simple robust design with a minimum of moving parts
- Proven to perform even in the harshest environments
- RSL2 – RSL20 model bodies and reaction arms are manufactured from high strength stainless steel. Reaction arms are available in weld-able cast steel. RSL30 bodies are made from high strength steel and reaction arms are made from high strength aluminium

## Dependable

- ISO certified with just three moving parts for reduced maintenance and a three year warranty

## Available as:

- Individual modules – power head, square drive head or low clearance hex heads

## Complete Tools:

- Square Drive Set (SDS) – power head, square drive wrench head, reaction arm
- Hex Wrench Set – power head, hex wrench head, reaction arm; full range of hex, bi-hex and special made to order
- PARKER ‘screw’ type connection as standard, high flow - quick release CEJN ‘none screw’ type connections also available



# Square Drive Wrench Dimensions and Specifications



## Square Drive Wrench Accessories

- Sockets – full range of hex, bi-hex, castellated and special made to order
- Direct-drive hexagon bits for socket head screws
- Direct-drive sockets, peg drive sockets, allen head driver

## Hex Wrench Accessories

- Inserts - full range of hex, bi-hex and special made to order
- Hexagon reducing inserts, made to order reaction arms, hose swivels - individual and multi-purpose

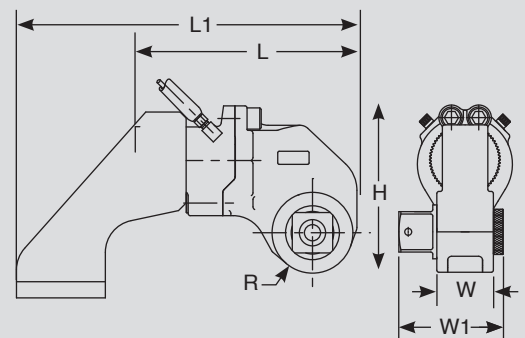

## Square Drive Dimensions and Specifications

Model	Wrench Head	Max. Torque Output		Sq. Drive Size	W (width)		W1 (width1)		H (height)		L (length)		L1 (length1)		R (radius)		Weight							
		lb-ft	N-m		in	in	mm	in	mm	in	mm	in	mm	in	mm	in	mm	lb	kg	lb	kg	lb	kg	
RSL2	Sq. Drive	1408	1909	3/4	1.25	32	2.30	58	4.48	114	6.29	160	7.45	189	0.94	24	3.98	1.81	0.50	0.23	2.53	1.15		
RSL4	Sq. Drive	3080	4176	1	1.50	38	2.88	73	5.57	141	7.67	195	10.30	262	1.25	32	5.69	2.58	2.28	1.03	4.75	2.15		
RSL6	Sq. Drive	5303	7190	1 1/2	1.75	45	3.71	94	6.42	163	9.27	235	11.67	296	1.52	39	9.00	4.08	3.96	1.80	9.08	4.12		
RSL8	Sq. Drive	7862	10659	1 1/2	2.40	61	4.14	105	6.65	169	9.47	241	11.78	300	1.52	39	10.80	4.90	4.32	1.96	11.25	5.10		
RSL14	Sq. Drive	11154	15123	1 1/2	2.50	64	4.63	118	7.93	201	11.20	284	12.40	315	1.88	48	11.63	5.28	6.54	2.96	16.62	7.54		
RSL20	Sq. Drive	18843	25548	2 1/2	3.25	83	6.38	162	9.48	241	13.46	342	18.97	482	2.50	64	20.10	9.12	15.90	7.21	29.04	13.17		
RSL30	Sq. Drive	28002	37965	2 1/2	3.50	89	6.54	169	10.35	263	14.09	358	21.07	536	2.50	64	21.34	9.68	11.00	4.99	36.75	16.67		

## Accessories (applicable to both Square drive and Hex wrenches)

### Handle

- Keep hands away from pinch points with this optional accessory
- Two options available: standard, and a low-clearance option for hex wrenches

### Hydratight 503 Moly Paste

- Hydratight 503 Moly Paste reduces friction on threaded fasteners – bolts, nuts, studs
- The low and uniform friction coefficient of 0.06 (torque coefficient, K, of 0.11) creates reliable assembly conditions
- Lubricant stays in place through heat, load and vibration to insure trouble-free disassembly from -29 to 399°C (-20 to 750°F)



# Hex Wrench Dimensions and Specifications

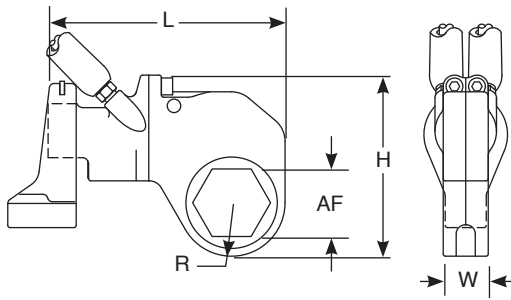

Hex Wrench Model and Housing	Max. AF Size		Max. Torque Output		R		L		W		H	
	mm	in	N-m	lb-ft	mm	in	mm	in	mm	in	mm	in
<b>RSL2H014</b>	22	7/8	433.9	320	20.1	0.79	152.4	6.00	31.8	1.25	110.0	4.33
101	27	1 1/16	867.7	640	24.1	0.95	153.7	6.05	31.8	1.25	114.3	4.50
104	31	1 1/4	867.7	640	26.2	1.03	155.4	6.12	31.8	1.25	116.1	4.57
107	36	1 7/16	1220.2	900	29.2	1.15	158.5	6.24	31.8	1.25	119.1	4.69
110	42	1 5/8	1909.0	1408	33.4	1.31	162.8	6.41	31.8	1.25	123.4	4.86
113	46	1 13/16	1909.0	1408	35.5	1.40	164.8	6.49	31.8	1.25	125.5	4.94
200	50	2	1909.0	1408	37.7	1.48	167.1	6.58	31.8	1.25	127.8	5.03
203	55	2 3/16	1909.0	1408	40.1	1.58	169.7	6.68	31.8	1.25	130.3	5.13
206	60	2 3/8	1909.0	1408	43.2	1.70	172.5	6.79	31.8	1.25	133.1	5.24
<b>RSL4H104</b>	32	1 1/4	813.5	600	26.2	1.03	189.2	7.45	35.1	1.38	135.9	5.35
107	36	1 7/16	1220.2	900	30.0	1.18	193.5	7.62	35.1	1.38	139.4	5.49
110	41	1 5/8	1627.0	1200	33.5	1.32	197.4	7.77	35.1	1.38	143.0	5.63
113	46	1 13/16	2576.0	1900	37.3	1.47	199.9	7.87	35.1	1.38	146.8	5.78
200	50	2	3525.1	2600	40.6	1.60	204.2	8.04	35.1	1.38	150.4	5.92
203	55	2 3/16	4175.9	3080	44.7	1.76	207.3	8.16	35.1	1.38	154.4	6.08
206	60	2 3/8	4175.9	3080	46.7	1.84	209.6	8.25	35.1	1.38	156.2	6.15
209	65	2 9/16	4175.9	3080	49.5	1.95	206.8	8.14	35.1	1.38	159.0	6.26
212	70	2 3/4	4175.9	3080	51.8	2.04	209.0	8.23	35.1	1.38	161.5	6.36
215	74	2 15/16	4175.9	3080	54.9	2.16	211.8	8.34	35.1	1.38	166.1	6.54
<b>RSL6H200</b>	50	2	3525.1	2600	40.9	1.61	230.6	9.08	44.5	1.75	165.6	6.52
203	55	2 3/16	4745.3	3500	43.4	1.71	233.2	9.18	44.5	1.75	168.1	6.62
206	60	2 3/8	6101.1	4500	47.5	1.87	237.2	9.34	44.5	1.75	172.2	6.78
209	65	2 9/16	7189.8	5303	51.1	2.01	240.8	9.48	44.5	1.75	175.8	6.92
212	70	2 3/4	7189.8	5303	54.9	2.16	244.6	9.63	44.5	1.75	179.6	7.07
215	75	2 15/16	7189.8	5303	56.9	2.24	246.6	9.71	44.5	1.75	181.6	7.15
302	80	3 1/8	7189.8	5303	57.4	2.26	247.1	9.73	44.5	1.75	182.1	7.17
<b>RSL8H203</b>	55	2 3/16	4745.3	3500	43.4	1.71	238.0	9.37	57.2	2.25	173.7	6.84
206	60	2 3/8	6101.1	4500	47.5	1.87	242.1	9.53	57.2	2.25	177.8	7.00
209	65	2 9/16	7863.6	5800	53.3	2.10	245.6	9.67	57.2	2.25	181.1	7.13
212	70	2 3/4	10659.3	7862	54.9	2.16	249.4	9.82	57.2	2.25	184.9	7.28
215	75	2 15/16	10659.3	7862	56.9	2.24	251.5	9.90	57.2	2.25	186.9	7.36
302	-	3 1/8	10659.3	7862	57.4	2.26	252.0	9.92	57.2	2.25	187.7	7.39
302	80	-	9897.3	7300	57.4	2.26	252.0	9.92	57.2	2.25	187.7	7.39
<b>RSL14H209</b>	65	2 9/16	7863.6	5800	50.3	1.98	254.0	10.00	63.5	2.50	204.0	8.03
212	70	2 3/4	9897.3	7300	55.6	2.19	284.5	11.20	63.5	2.50	209.0	8.23
215	75	2 15/16	12202.2	9000	58.2	2.29	287.3	11.31	63.5	2.50	211.8	8.34
302	79	3 1/8	15122.6	11154	61.7	2.43	290.6	11.44	63.5	2.50	215.1	8.47
308	89	3 1/2	15122.6	11154	66.0	2.60	297.4	11.71	63.5	2.50	219.5	8.64
314	98	3 7/8	15122.6	11154	73.2	2.88	302.0	11.89	63.5	2.50	226.6	8.92
404	108	4 1/4	15122.6	11154	75.7	2.98	304.8	12.00	63.5	2.50	229.4	9.03
410	117	4 5/8	15122.6	11154	82.6	3.25	311.7	12.27	63.5	2.50	236.2	9.30
<b>RSL20H302</b>	79	3 1/8	14913.8	11000	62.2	2.45	323.1	12.72	69.9	2.75	239.8	9.44
308	89	3 1/2	21692.8	16000	70.4	2.77	331.2	13.04	69.9	2.75	247.9	9.76
314	98	3 7/8	25547.3	18843	74.9	2.95	335.8	13.22	69.9	2.75	252.5	9.94
404	108	4 1/4	25547.3	18843	83.8	3.30	344.7	13.57	69.9	2.75	261.1	10.28
410	117	4 5/8	25547.3	18843	87.4	3.44	348.2	13.71	69.9	2.75	264.9	10.43
<b>RSL30H308</b>	89	3 1/2	21692.8	16000	65.0	2.56	364.7	14.36	76.2	3.00	267.7	10.54
314	98	3 7/8	29827.6	22000	74.2	2.92	364.7	14.36	76.2	3.00	273.6	10.77
404	108	4 1/4	37965.1	28002	83.6	3.29	367.5	14.47	76.2	3.00	283.0	11.14
410	117	4 5/8	37965.1	28002	87.1	3.43	371.1	14.61	76.2	3.00	286.5	11.28
500	127	5	37965.1	28002	92.7	3.65	376.7	14.83	76.2	3.00	292.1	11.50
506	136	5 3/8	37965.1	28002	96.3	3.79	380.2	14.97	76.2	3.00	295.7	11.64
512	146	5 3/4	37965.1	28002	102.9	4.05	386.8	15.23	76.2	3.00	302.3	11.90
602	155	6 1/8	37965.1	28002	107.2	4.22	393.2	15.48	76.2	3.00	308.6	12.15



# Hex Wrench Capacity Table

Hex Sizes	Nut Size (A/F)		Stud Size (Dia)		RSL2H (3/4" Sq Dr.) 1408/1909 lbf-ft/N-m	RSL4H (1" Sq Dr.) 3080/4180 lbf-ft/N-m	RSL6H (1"-1/2" Sq Dr.) 5325/7220 lbf-ft/N-m	RSL8H (1"-1/2" Sq Dr.) 7860/10660 lbf-ft/N-m	RSL14H (1"-1/2" Sq Dr.) 11150/15120 lbf-ft/N-m	RSL20H (2"-1/2" Sq Dr.) 18843/25548 lbf-ft/N-m	RSL30H (2"-1/2" Sq Dr.) 28000/37970 lbf-ft/N-m
	inch	mm	inch	metric							
H10M		10		6BR 12S							
H12MF		12		14S							
H006	1/2		1/4H 5/16BR 5/8S								
H13M		13		8B6 10L							
H14MF		14		16S							
H009	9/16		3/8BR 5/16H								
H15M		15		12F 10L							
H010	5/8		7/16B 3/4S								
H16M		16		10BR							
H17MF		17		20S							
H011	11/16		3/8H 7/16R								
H18M		18		12BR 14L							
H19MF		19		24S							
H012	3/4		7/16 1/2BR 7/8 1S								
H013	13/16		9/16B								
H21M		21		12BH 14BR 16L							
H22MF		22		30S							
H014	7/8		9/16R 1/2BH 1-1/8S 1-1/4 S		320/434						
H015	15/16		5/8BR 9/16H								
H24M		24		16BRH 14BH							
H100F	1		1-3/8S 1-1/2S								
H101	1-1/16	27	5/8BH	36S	640/868						
H102	1-1/8RB		3/4								
H30M		30		20RB	640/868	600/814					
H104	1-1/4H		3/4								
H105	1-5/16R		7/8								
H32M		32		42S							
H34M		34		20H							
H35M		35									
H36M		36		24RB 22H 48S							
H107	1-7/16H		7/8		900/1220	900/1220					
H32MF		32		42S							
H106	1-1/2RB		1								
H40M		40									
H42M											
H110	1-5/8H	41	1	24H	1408/1909	1200/1627					
H111	1-11/16B		1-1/8								
H45M		45									
H113	1-13/16H	46	1-1/8	30RB 27H	1408*/1909	1900/2576					
H114	1-7/8B		1-1/4								
H50M		50		30H							
H200	2H		1-1/4		1408*/1909	2600/3525	2600/3525				
H201	2-1/16B		1-3/8								
H55M		55		36RB							
H203	2-3/16H		1-3/8		1408*/1909	3080*/4176	3500/4745	3500/4745			
H204	2-1/4B		1-1/2								
H60M		60		36H							
H206	2-3/8H		1-1/2		1408*/1909	3080*/4176	4500/6101	4500/6101			
H209	2-9/16H	65	1-5/8	42RB		3080*/4176	5303/7190	5800/7864	5800/7864		
H210	2-5/8B		1-3/4								
H212	2-3/4H	70	1-3/4	42H		3080*/4176	5303/7190	7860/10660	7300/9897		
H213	2-13/16B		1-7/8								
H215	2-15/16H	75	1-7/8	48RB		3080*/4176	5303/7190	7860*/10660	9000/12202		
H300	3B		2								
H302	3-1/8H		2				5303/7190	7860*/10660	11150/15120	11000/14916	
H80M		80		48H			5303/7190	7300*/9900			
H85M		85		56RB							
H306	3-3/8B		2-1/4								
H306	3-1/2H		2-1/4								
H90M		90		56H					11150*/15120	16000/21700	16000/21700
H312	3-3/4	95	2-1/2	64RB							
H314	3-7/8		2-1/2						11150*/15120	18843/25547	22000/29840
H100M		100		64H							
H402	4-1/8B	105	2-3/4	72RB							
H404	4-1/4H		2-3/4						11150*/15120	18843/25547	28000/37970
H110M		110		72H							
H408	4-1/2B		3								
H115M		115		80RB							
H410	4-5/8		3						11150*/15120	18843/25547	28000*/37970
H120M		120		80H							
H414	4-7/8B		3-1/4								
H500	5H		3-1/4								28000*/37970
H130M		130		90RB							
H504	5-1/4B		3-1/2								
H135M		135		90H							
H506	5-3/8H		3-1/2								28000*/37970
H510	5-5/8B		3-3/4								
H145M		145		100RB							
H512	5-3/4		3-3/4								28000*/37970
H150M		150		100H							
H600	6B		4								
H155M		155									
H602	6-1/8H		4								28000*/37970

Legend: R=Regular Hex H=Heavy Hex  
 B=Hex Bolt L=Flange Screw  
 M=Metric S=Socket Head Cap Screw

\*Use 503 and reduce loosening/tightening torque, for temperatures below 650°F

Producible Available Suggested selection Not available

# BOP Hex Wrench

This versatile, high performance tool has been specifically created for arduous applications with limited clearances.



A purpose-designed modification of a standard wrench, it has a narrowed tip on the nose of the housing which makes it uniquely equipped to access tight spaces offering little room for manoeuvre, such as over the top of awkwardly-located studs on Blow Out Preventors. The max torque output is reduced, with less than half of the torque value of a standard sized wrench and a narrowed width of W1 for increased accessibility.

This narrow dimension makes the BOP Hex Tool supremely well equipped for any bolted flange where space is severely restricted.

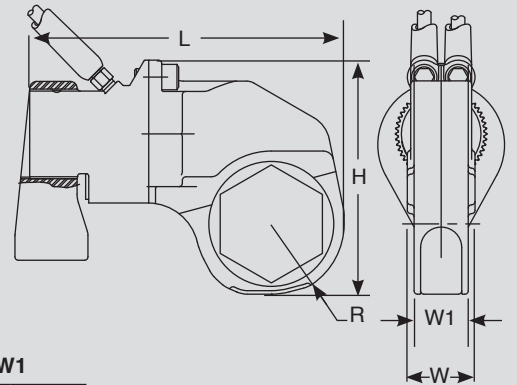

Model Number		Max. AF Size		Max. Torque Output		W		W1	
		inch	mm	lb-ft	N-m	inch	mm	inch	mm
<b>RSL2</b>	RSL2H104BOP	1 1/4	31	379	514	1.25	31.75	1.0	25.4
	RSL2H107BOP	1 7/16	36	660	895	1.25	31.75	1.0	25.4
	RSL2H110BOP	1 5/8	42	835	1132	1.25	31.75	1.0	25.4
	RSL2H113BOP	1 13/16	46	835	1132	1.25	31.75	1.0	25.4
	RSL2H200BOP	2	50	835	1132	1.25	31.75	1.0	25.4
<b>RSL4</b>	RSL4H200BOP	2	50	1374	1863	1.25	34.95	1.13	28.6
	RSL4H203BOP	2 3/16	55	1627	2206	1.38	34.95	1.13	28.6
	RSL4H212BOP	2 3/4	70	1627	2206	1.38	34.95	1.13	28.6
	RSL4H215BOP	2 15/16	74	1627	2206	1.38	34.95	1.13	28.6
	RSL4H209BOP	2 9/16	65	1627	2206	1.38	34.95	1.13	28.6
<b>RSL6</b>	RSL6H302SLIM	3 1/8	80	4173	5658	1.75	44.45	1.62	41.15
	RSL8H206BOP	2 3/8	60	3198	4336	2.25	57.15	2.0	50.8
	RSL8H209BOP	2 9/16	65	4122	5589	2.25	57.15	2.0	50.8
<b>RSL8</b>	RSL8H212BOP	2 3/4	70	5587	7575	2.25	57.15	2.0	50.8
	RSL8H215BOP	2 15/16	74	5587	7575	2.25	57.15	2.0	50.8
	RSL8H302BOP	3 1/8	80	5587	7575	2.25	57.15	2.0	50.8

Length, height and radius values are the same as the Hex Wrench on page 6



# Pneumatic Torque Tools

The Pneumatic Torque Tool range has been designed specifically with the user in mind. When a powered bolting solution is needed for high torque fasteners, our pneumatic tools provide reliable, high performance and accurate torque control.



Hydratight's ongoing commitment to product development and technical innovation has led to the introduction of five distinct pneumatic torque tools providing new levels of operational versatility and accuracy.

## Features and Benefits:

- Designed specifically for the user in mind, the Pneumatic Torque Tool range offers unrivalled precision and torque control, with the ability to torque an application in sequence without having to readjust the pressure setting
- Our innovative design of the CP air motor means that the operators required hand force is negligible, enhancing operator safety, with an output of 2Nm - 50% lower than existing market tooling
- Our tool range produces the lowest air requirement of 24 CFM (40m<sup>3</sup>/h), making each tool versatile and sets it apart from existing market offerings which normally have air requirements up to 40 or 50 CFM (70m<sup>3</sup>/h or 85m<sup>3</sup>/h). This makes each tool perfectly suited to deliver durable performance in many locations, including remote field applications
- The ergonomic designed pistol grip swivel ensures the user can produce torque up to 5,000 ft.lbs (407 Nm to 6800 Nm) with minimal impact
- The two stage gear box design expands the torque range of the tools from 300 to 5,000 ft.lbs (6800 Nm); this flexibility allows the user scope to use the tools in a wider range applications. The tool also allows the user to torque an application in sequence without having to readjust the pressure setting
- A single air setting allows a user to switch from fast run down to final torque with the flick of a switch

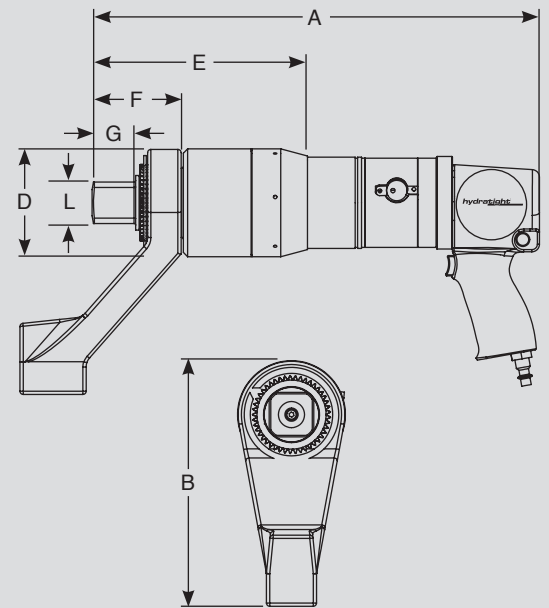

## Technical Details:

These five pneumatic torque tools feature a market-leading 24 CFM (40m<sup>3</sup>/h) requirement, 12"-18" (304.8mm - 457.2mm) on the pistol grip, 2Nm of output, Lubro Control Unit w/Hoses and custom reaction arms.

Model	HPT 7		HPT 13		HPT 30		HPT 40		HPT 50	
	mm	inch	mm	inch	mm	inch	mm	inch	mm	inch
A	307.4	12.10	319.3	12.57	367.3	14.46	402.3	15.84	434.3	17.10
B	190.5	7.50	190.5	7.50	190.5	7.50	190.5	7.50	190.5	7.50
C	82	3.23	82	3.23	82	3.23	82	3.23	82	3.23
D	74.2	2.92	93	3.66	98	3.86	99	3.90	120.1	4.73
E	125.2	4.93	140.2	5.52	150.1	5.91	162.1	6.38	218.2	8.59
F	57.2	2.25	61.0	2.40	73.2	2.88	86.1	3.39	98.0	3.86
G	24.1	0.95	26.9	1.06	26.9	1.06	40.1	1.58	41.9	1.65
<b>Torque Range (Ft-lbs)</b>	60-600		100-1300		250-3000		400-4000		500-5000	
<b>Torque Range (Nm)</b>	80-815		135-1760		400-4050		540-5420		670-6780	
<b>Drive Size (L)</b>	3/4"		1"		1"		1-1/2"		1-1/2"	
<b>Weight</b>	5 kg / 11 lbs		6.4 kg / 14 lbs		8.2 kg / 18 lbs		8.6 kg / 19 lbs		13.2 kg / 29 lbs	
<b>Idling RPM</b>	60		25		10		8		6	

# Power Consoles

The Hydratight range of portable 10,000 psi ultra high performance pumps has been designed and developed specifically for use with hydraulic torque wrenches.

Pumps operate from two primary power sources: air and electric, providing optimum performance of power and speed, even in the most arduous conditions. Each Hydratight pump ensures user safety – operation via a remote control handset comes as standard.



PowaPak Electric Ultra

## PowaPak Air

A high pressure air powered hydraulic torque wrench pump, designed specifically for bolting applications.

## PowaPak Air Ultra

A new high efficiency air powered, torque wrench pump which maximises operational speeds of hydraulic wrenches, the three stage hydraulic design can reduce wrench cycle operations by up to 60%.

## PowaPak Electric

A high pressure electric torque wrench pump with backlit LCD display and microprocessor control, combining performance with long life and low maintenance.

## PowaPak Electric Automatic

Fully automatic, this PowaPak pump provides industry leading performance and high levels of reliability, all in a high quality compact design.

## PowaPak Electric Ultra

All of the performance benefits of the PowaPak Automatic with the added benefits of a fully programmable SMART multi-function microprocessor control.



PowaPak Air



PowaPak Air Ultra



PowaPak Electric



PowaPak Electric Automatic

# Complementary Products

Hydratight offers complementary bolting solutions and application technologies, which carry on our tradition of innovation and exacting standards.

## Torque Multipliers

Hydratight's torque multipliers are a perfect solution in areas of remote locations without power sources; safe operation by manual intervention produces the complete tightening solution for any application.

Small amounts of input torque are translated into large amounts of output torque, efficiently and safely, requiring very little effort for the accurate make-up or break-out of a stubborn fastener.

Extremely durable and reversible, the performance of this impressive range of torque multipliers is matched by a unique range of features, including:

- Overload protection which shields the tool from internal damage
- Anti-backlash device
- Consistently high efficiency by using planetary gear sets
- Input / output torque charts
- Angle of turn protractor
- Multiple styles of reaction
- Application support and customer reaction anchors (available on request)

## Bolt Load Monitoring

Hydratight's unrivalled position at the forefront of Bolt Load Monitoring technology has been established with the development of the Boltscope II and more recently, the Boltscope Pro.

Each one ultrasonically measures the actual load in the fastener at the point of loading and throughout its service life.

Applicable to all methods of fastener tightening from Torque Multipliers to Hydraulic Bolt Tensioners, they are ideally suited for any application requiring accurate fastener tension measurements.

**To find out more about these or any additional products and services which Hydratight offers, please visit [hydratight.com](http://hydratight.com).**



Torque Multiplier



Boltscope Pro

# hydratight®

Our global network means you can rely on the right people, products and services wherever you are in the world.

Email us at: [solutions@hydratight.com](mailto:solutions@hydratight.com)  
Or find your local representative at:  
[hydratight.com/contact](http://hydratight.com/contact)

